

# DETAIL A

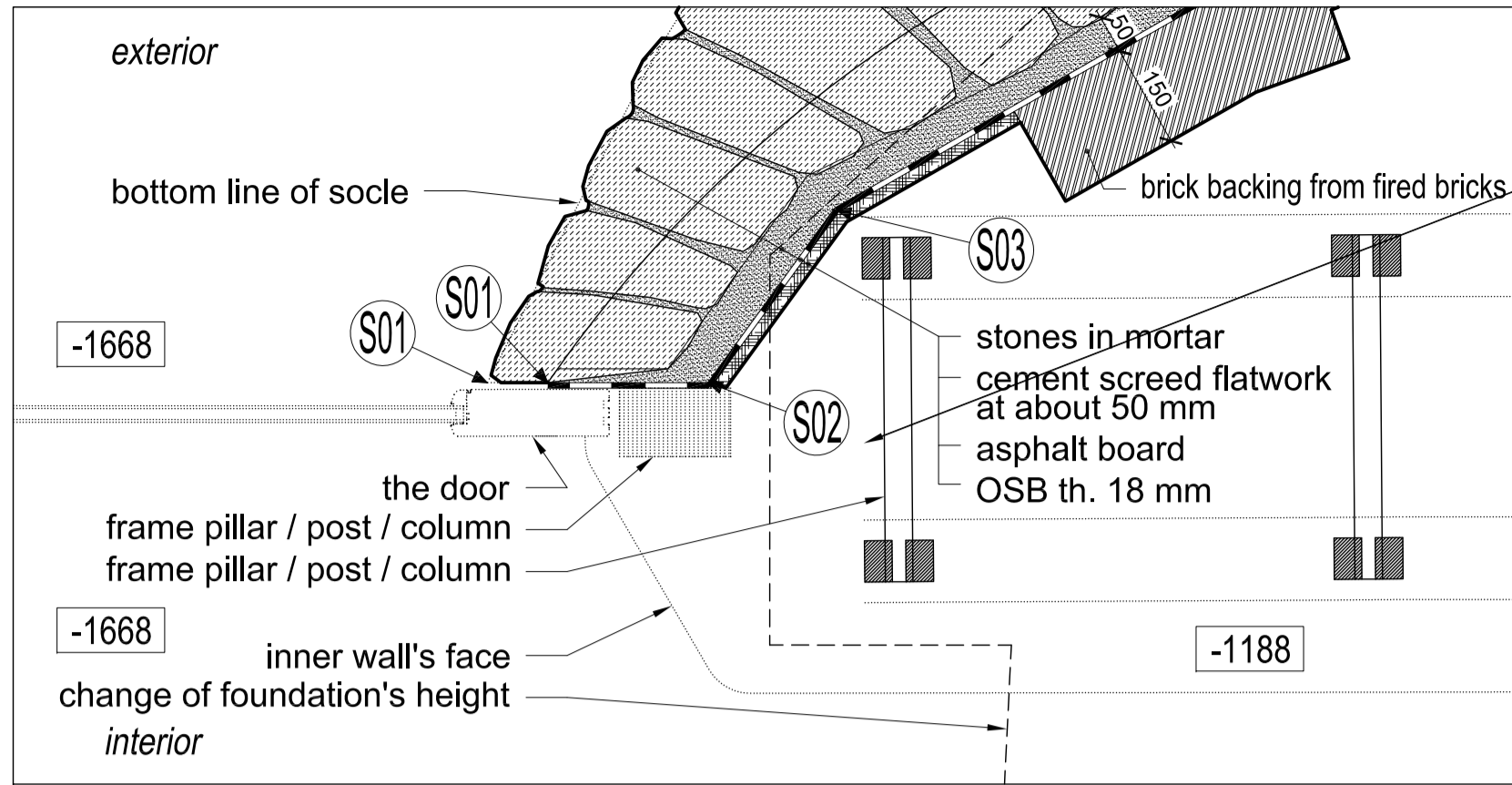

# DETAIL C

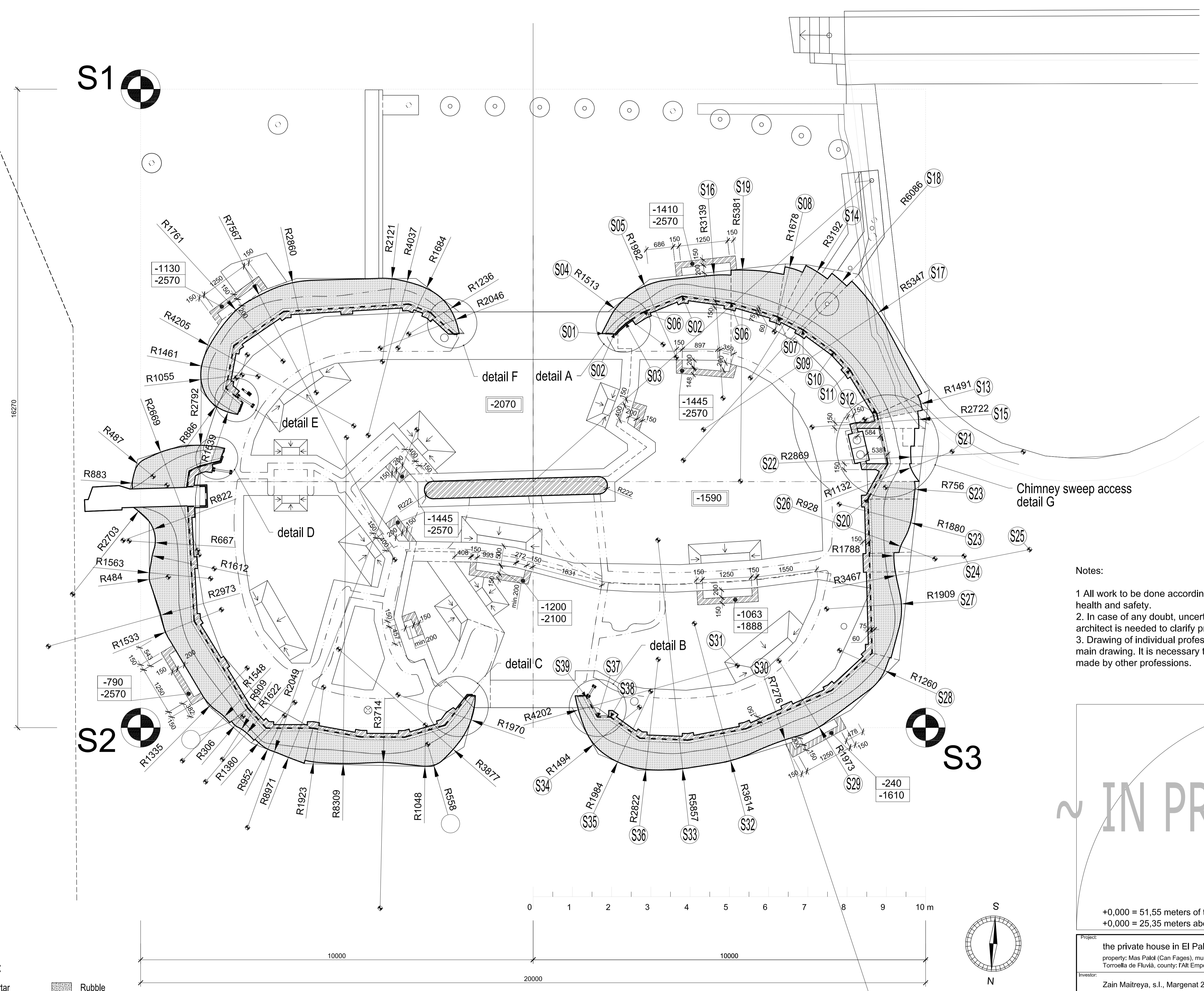
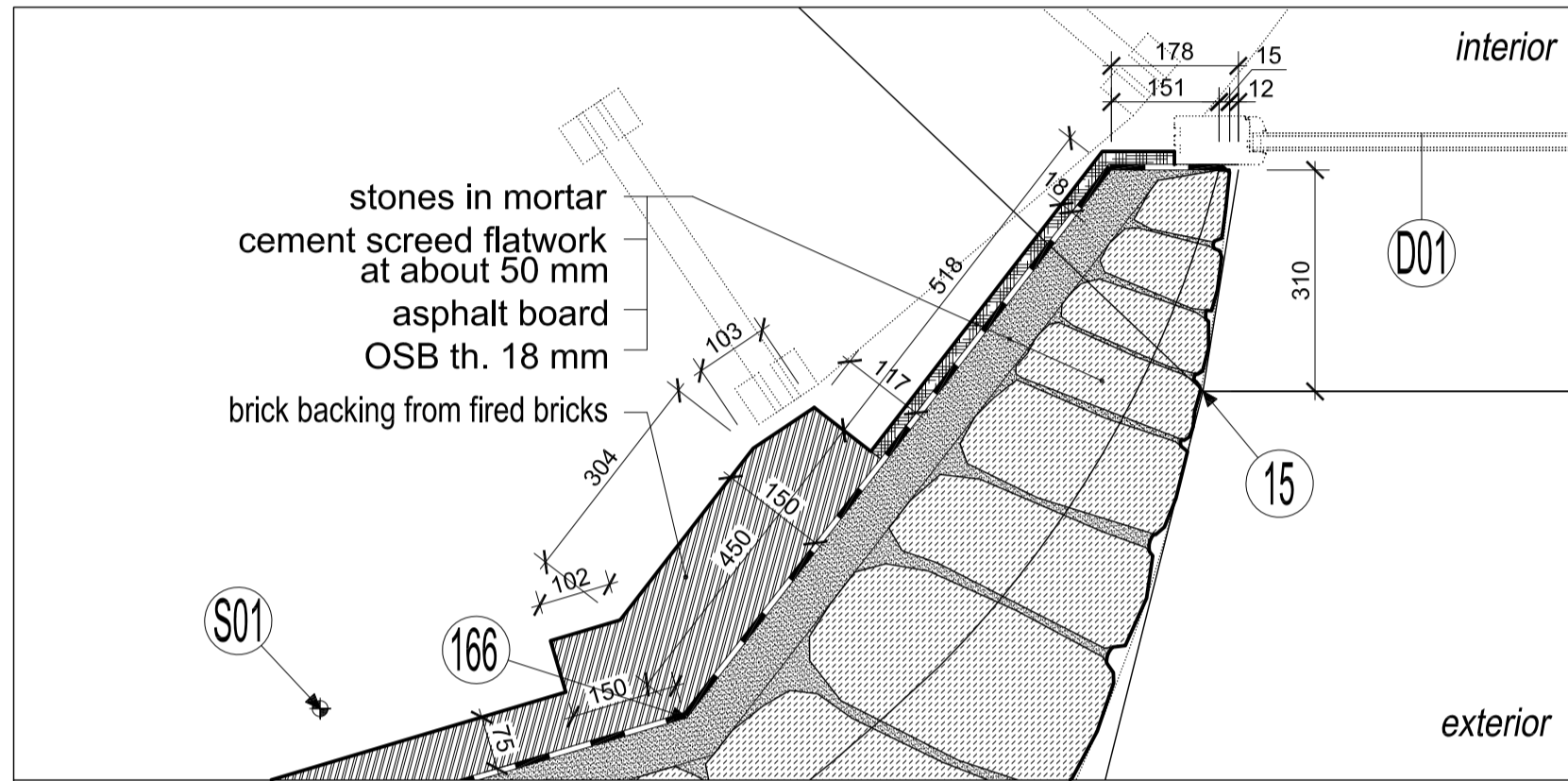

- Legend of materials:**
- Stones in cement mortar
  - Stone wall - Exposed stonework
  - Fired bricks
  - cement screed for closing top of the stone wall
  - Rubble
  - Terrain
  - Stone Arch

coordination point marking out distances to numbered points



upper face of foundation -1668  
bottom face of foundation -2570  
elevation of terrain -2070

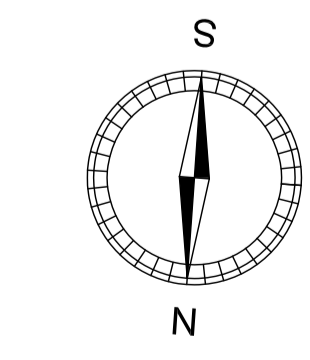

- Notes:**
- 1 All work to be done according to current regulations and technology rules, including health and safety.
  2. In case of any doubt, uncertainty or unforeseen circumstances consultation with the architect is needed to clarify progress of work.
  3. Drawing of individual professions and other documentation on the list are part of the main drawing. It is necessary to coordinate building structure drawings and adjustments made by other professions.

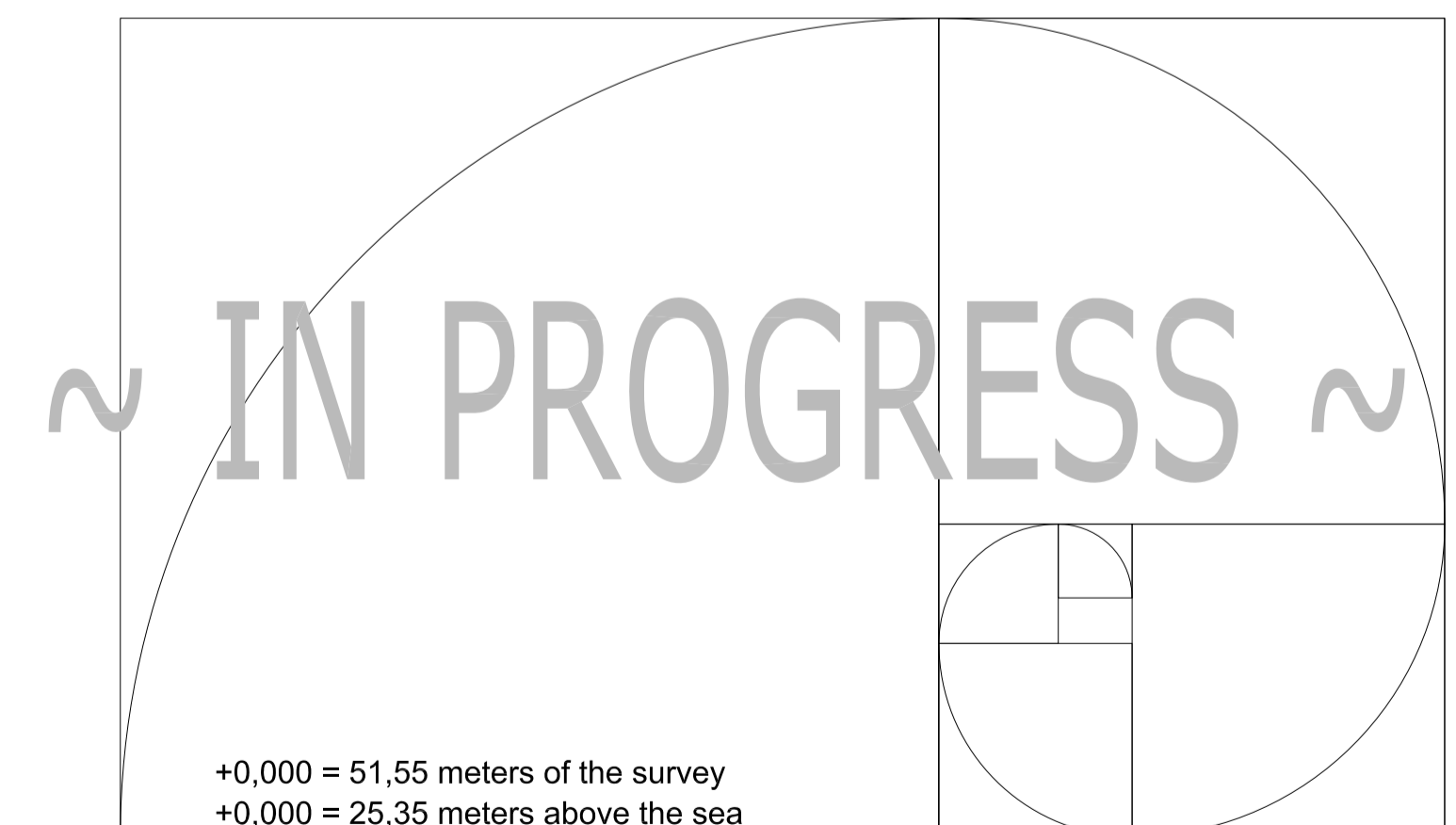

+0,000 = 51,55 meters of the survey  
+0,000 = 25,35 meters above the sea

Project: the private house in El Palol property: Mas Palol (Can Fages), municipal area: Torroella de Fluvià, county: l'Alt Empordà, Spain			
Investor: Zain Maitreya, s.l., Margenat 23, 08017 Barcelona, Spain		ar. arch. Oldřich Hozman No. Zapsis 01, 01.00 Praha 03 Czech Republic Czech Chamber of Architects Reg. no. 01204 tel +420 226 21 18 22 fax +420 226 21 14 22 www.ahc.cz   ah@ahc.cz	
Architect: ak. arch. Oldřich Hozman	Drawn by: Bc. Jan Soukup	Profession: xxxx	A4 format: 8
Structural engineer: Joan Carles Capilla Ten and Maria Pia Monaco Baques, arquitectes		Controller: arch. Arturo de la Maza	
Drawing: <b>FOUNDATIONS</b> SOCLE BOTTOM		State of the project: EXECUTIVE PROJECT	Drawing number: <b>04</b>
Scale: 1 : 50		Date: 11 / 2009	