

Project: the private house in El Palol property: Mas Palol (Can Fages), municipal area: Torroella de Fluvià, county: l'Alt Empordà, Spain	 <p> <i>ak. arch. Oldřich Hozman</i> <i>Na Zájezdu 16, 101 00 Praha 10</i> <i>Czech Republic</i> <i>Czech Chamber of Architects Reg. no.: 01284</i> <i>tel + 4 20 2 35 31 16 22</i> <i>fax + 4 20 2 35 31 16 22</i> <i>www.arc.cz arc@arc.cz</i> </p>
Investor: Zain Maitreya, s.l., Margenat 23, 08017 Barcelona, Spain	

Architect: ak. arch. Oldřich Hozman	Drawn by: Ing. arch. Jan Soukup Ing. Tomas Stopka	Profession: CONSTRUCTION	Format: A4,A3,A0
Structural engineer: Joan Carles Capilla Ten and Maria Pia Monaco Baques, arquitectes		Checked by: arch. Arturo de la Maza	

Drawing: CARPENTRY ELEMENTS SCHEDULE	Project stage: EXECUTIVE PROJECT	Drawing number: SCH4
	Scale: 1:5, 1:10, 1:20, 1:50	
	Date: 07 / 2011	

C01

main interior staircase

for details see DET1 - DET5

Note: Exact measurements to be taken on site prior to construction.

C02

interior staircase at main entrance

for details see DET6 - DET7

Note: Exact measurements to be taken on site prior to construction.

C03

interior staircase in the living-room

for details see DET8 - DET10

Note: Exact measurements to be taken on site prior to construction.

C04

wooden hand rail - main interior staircase

for details see DET03, DET11

Note: Exact measurements to be taken on site prior to construction.

C05

wooden hand rail - main interior staircase

for details see DET04

Note: Exact measurements to be taken on site prior to construction.

C06

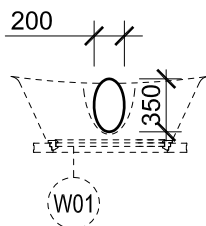

wooden window sill (interior)

ellipse (350x200mm)
massive wooden board th. 30mm
rounded edges, perimeter 10mm
finish: hard wax oil (ref. Kreidezeit)
fixed to the niche in rounded brick jamb

for details see Section 20

Note: Exact measurements to be taken on site prior to construction.

C07

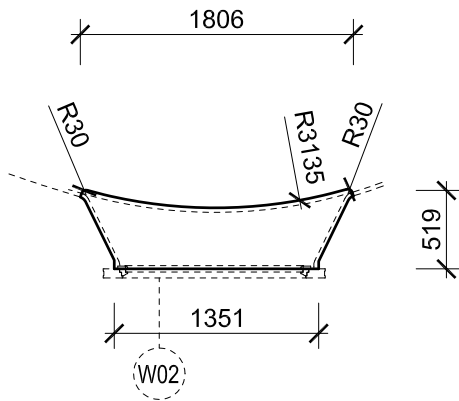

wooden window sill (interior)

massive wooden board th. 30mm
rounded front edges, perimeter 10mm
finish: hard wax oil (ref. Kreidezeit)

Note: Exact measurements to be taken on site prior to construction.

C08

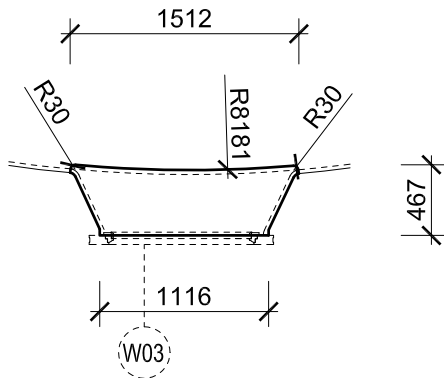

wooden window sill (interior)

massive wooden board th. 30mm
rounded front edges, perimeter 10mm
finish: hard wax oil (ref. Kreidezeit)

Note: Exact measurements to be taken on site prior to construction.

C09

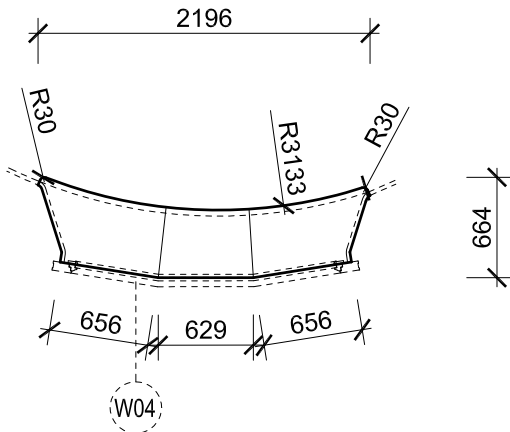

wooden window sill (interior)

massive wooden board th. 30mm
rounded front edges, perimeter 10mm
finish: hard wax oil (ref. Kreidezeit)

Note: Exact measurements to be taken on site prior to construction.

C10

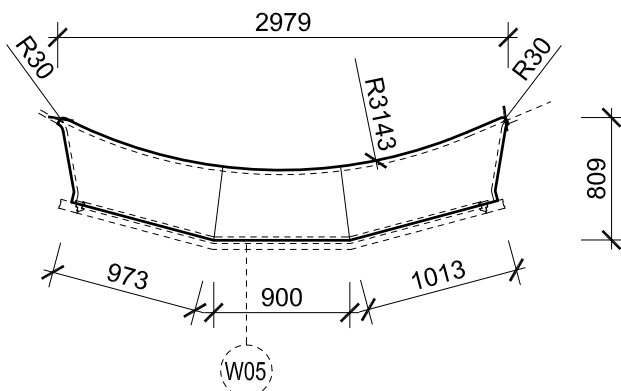

wooden window sill (interior)

massive wooden board th. 30mm
rounded front edges, perimeter 10mm
finish: hard wax oil (ref. Kreidezeit)

Note: Exact measurements to be taken on site prior to construction.

C07

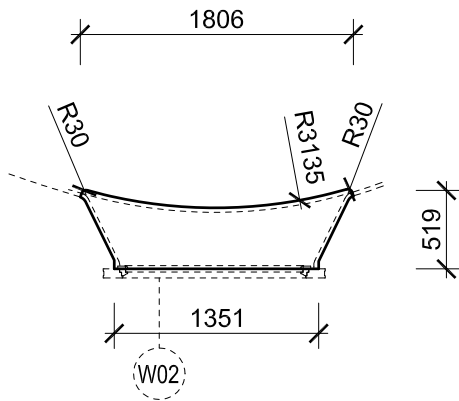

wooden window sill (interior)

massive wooden board th. 30mm
 rounded front edges, perimeter 10mm
 finish: hard wax oil (ref. Kreidezeit)

Note: Exact measurements to be taken on site prior to construction.

C08

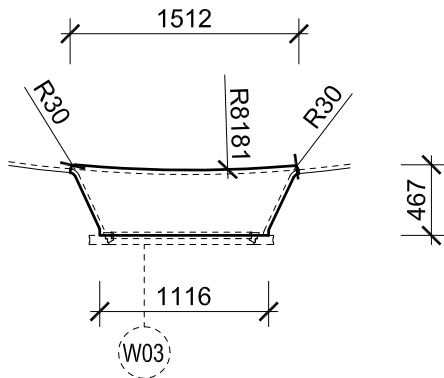

wooden window sill (interior)

massive wooden board th. 30mm
 rounded front edges, perimeter 10mm
 finish: hard wax oil (ref. Kreidezeit)

Note: Exact measurements to be taken on site prior to construction.

C09

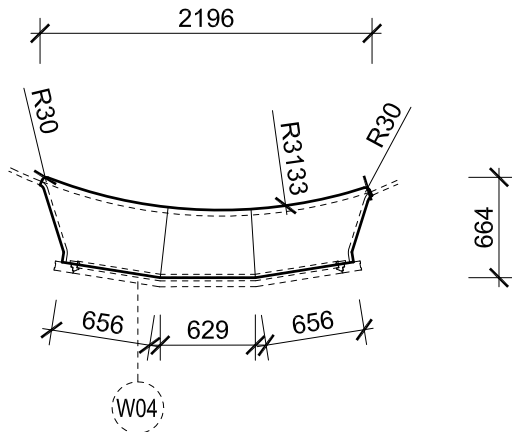

wooden window sill (interior)

massive wooden board th. 30mm
 rounded front edges, perimeter 10mm
 finish: hard wax oil (ref. Kreidezeit)

Note: Exact measurements to be taken on site prior to construction.

C10

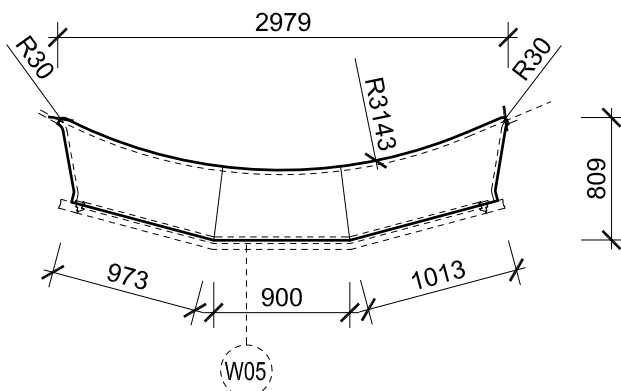

wooden window sill (interior)

massive wooden board th. 30mm
 rounded front edges, perimeter 10mm
 finish: hard wax oil (ref. Kreidezeit)

Note: Exact measurements to be taken on site prior to construction.

C11

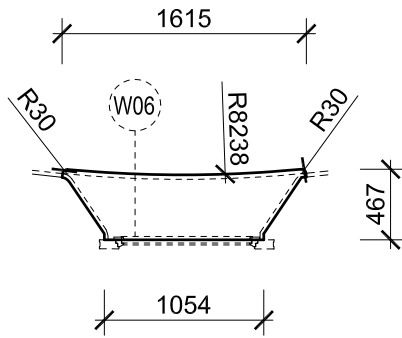

wooden window sill (interior)

massive wooden board th. 30mm
rounded front edges, perimeter 10mm
finish: hard wax oil (ref. Kreidezeit)

Note: Exact measurements to be taken on site prior to construction.

C12

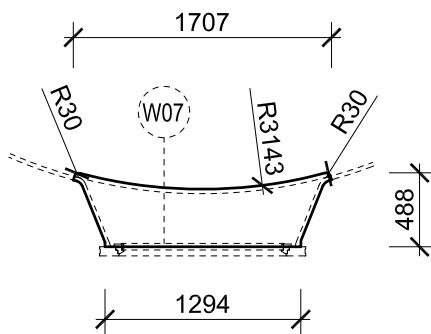

wooden window sill (interior)

massive wooden board th. 30mm
rounded front edges, perimeter 10mm
finish: hard wax oil (ref. Kreidezeit)

Note: Exact measurements to be taken on site prior to construction.

C13

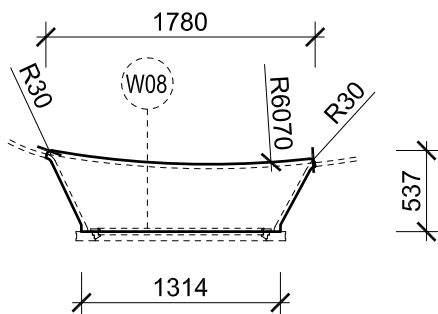

wooden window sill (interior)

massive wooden board th. 30mm
rounded front edges, perimeter 10mm
finish: hard wax oil (ref. Kreidezeit)

Note: Exact measurements to be taken on site prior to construction.

C14

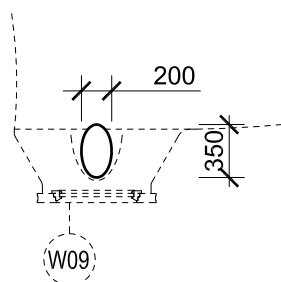

wooden window sill (interior)

ellipse (350x200mm)
massive wooden board th. 30mm
rounded edges, perimeter 10mm
finish: hard wax oil (ref. Kreidezeit)
fixed to the niche in rounded brick jamb

for details see Section 20

Note: Exact measurements to be taken on site prior to construction.

C15

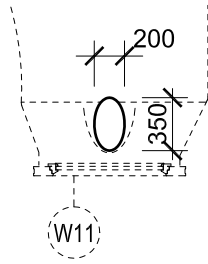

wooden window sill (interior)

ellipse (350x200mm)
massive wooden board th. 30mm
rounded edges, perimeter 10mm
finish: hard wax oil (ref. Kreidezeit)
fixed to the niche in rounded brick jamb

for details see Section 20

Note: Exact measurements to be taken on site prior to construction.

C16

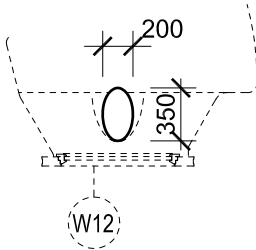

wooden window sill (interior)

ellipse (350x200mm)
massive wooden board th. 30mm
rounded edges, perimeter 10mm
finish: hard wax oil (ref. Kreidezeit)
fixed to the niche in rounded brick jamb

for details see Section 20

Note: Exact measurements to be taken on site prior to construction.

C17

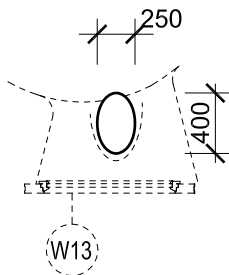

wooden window sill (interior)

ellipse (400x250mm)
massive wooden board th. 30mm
rounded edges, perimeter 10mm
finish: hard wax oil (ref. Kreidezeit)
fixed to the niche in rounded brick jamb

for details see Section 20

Note: Exact measurements to be taken on site prior to construction.

C18

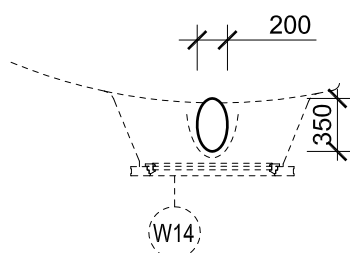

wooden window sill (interior)

ellipse (350x200mm)
massive wooden board th. 30mm
rounded edges, perimeter 10mm
finish: hard wax oil (ref. Kreidezeit)
fixed to the niche in rounded brick jamb

for details see Section 20

Note: Exact measurements to be taken on site prior to construction.

C19

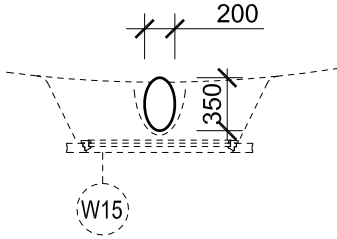

wooden window sill (interior)

ellipse (350x200mm)
massive wooden board th. 30mm
rounded edges, perimeter 10mm
finish: hard wax oil (ref. Kreidezeit)
fixed to the niche in rounded brick jamb

for details see Section 20

Note: Exact measurements to be taken on site prior to construction.

C20

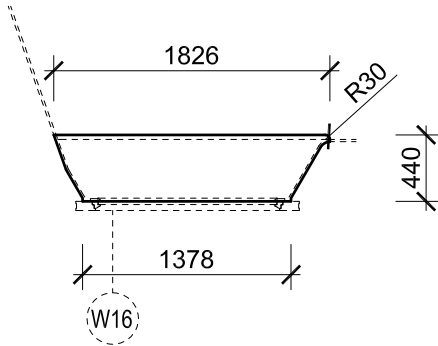

wooden window sill (interior)

massive wooden board th. 30mm
rounded front edges, perimeter 10mm
finish: hard wax oil (ref. Kreidezeit)

Note: Exact measurements to be taken on site prior to construction.

C21

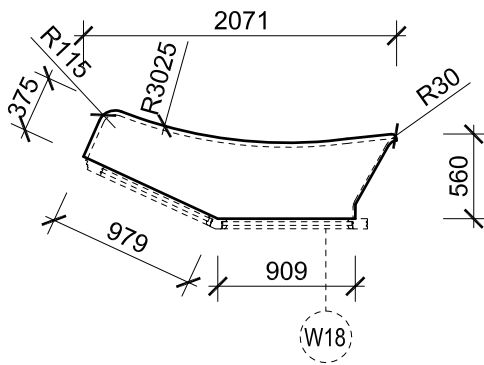

wooden window sill (interior)

massive wooden board th. 30mm
rounded front edges, perimeter 10mm
finish: hard wax oil (ref. Kreidezeit)

Note: Exact measurements to be taken on site prior to construction.

C22

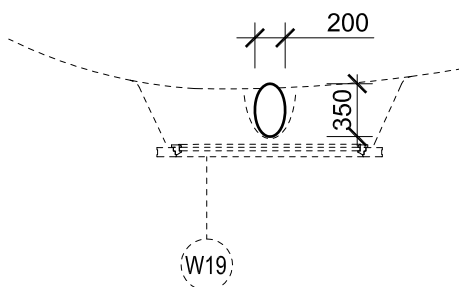

wooden window sill (interior)

ellipse (350x200mm)
massive wooden board th. 30mm
rounded edges, perimeter 10mm
finish: hard wax oil (ref. Kreidezeit)
fixed to the niche in rounded brick jamb

for details see Section 20

Note: Exact measurements to be taken on site prior to construction.

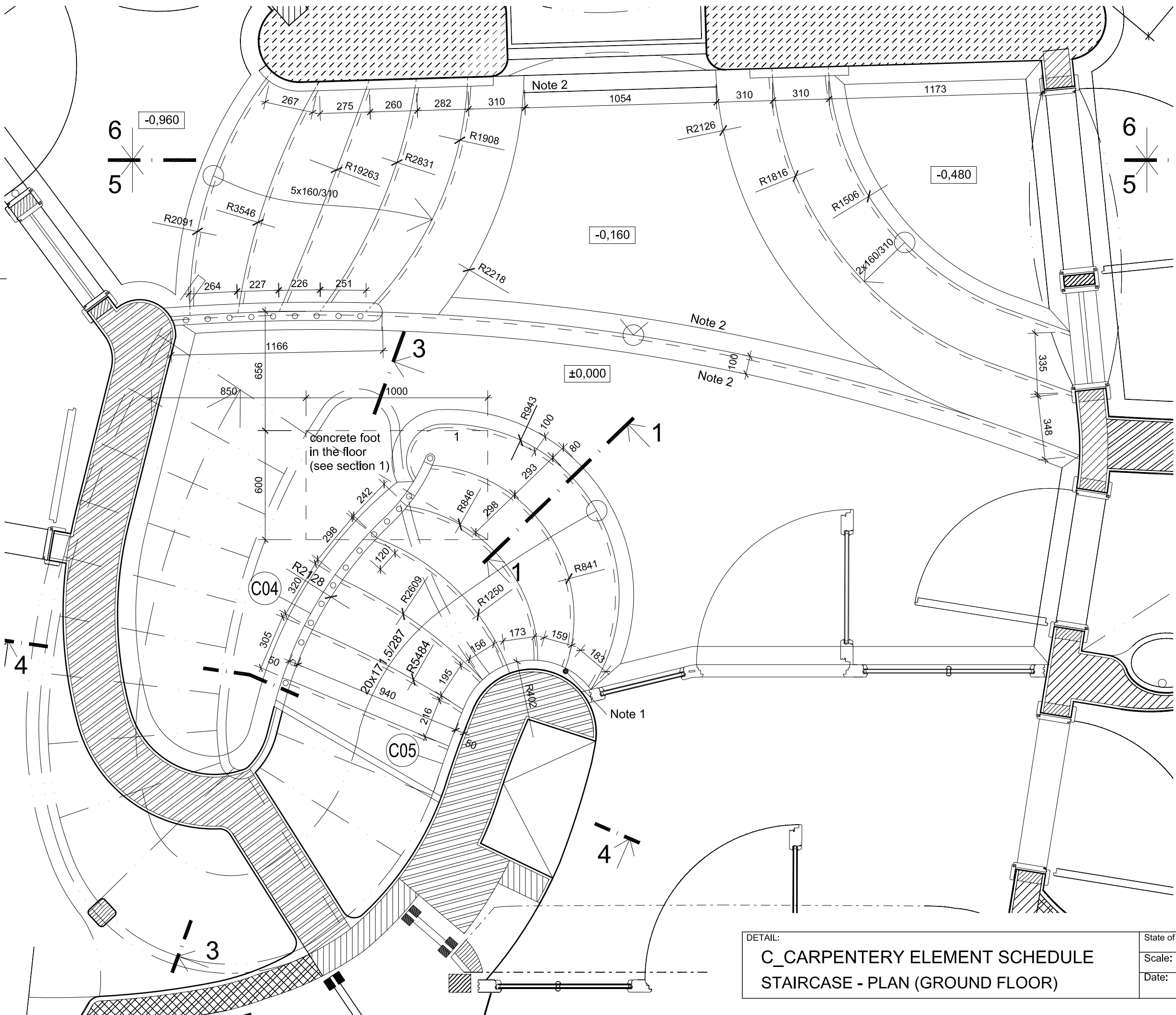

THE KEY OF MATERIALS

	BRICKWORK TH.140mm
	BRICKWORK TH.270mm
	CLAY-BRICKWORK TH.140mm
	STONEWORK (EXPOSED) TH.450mm
	AAC BLOCKS (YTONG) TH.75mm
	AAC BLOCKS (YTONG) TH.150mm







Notes:
 Note 1: Wooden stair stringer fixed sideways to brickwall
 Note 2: wooden lining plank (100x40) along the border of stone paving

1 All work to be done according to current regulations and technology rules, including health and safety.
 2. In case of any doubt, uncertainty or unforeseen circumstances consultation with the architect is needed to clarify progress of work.
 3. Drawings of individual professions and other documentation on the list are part of the main drawing. It is necessary to coordinate building structure drawings and adjustments made by other professions.

DETAIL: C_CARPENTRY ELEMENT SCHEDULE STAIRCASE - PLAN (GROUND FLOOR)	State of the project: EXECUTIVE PROJECT	Drawing number:
	Scale: 1 : 20	Detail 01
	Date: 05 / 2011	



THE KEY OF MATERIALS

-  BRICKWORK TH.140mm
-  BRICKWORK TH.270mm
-  CLAY-BRICKWORK TH.140mm
-  STONEWORK (EXPOSED) TH.450mm
-  AAC BLOCKS (YTONG) TH.75mm
-  AAC BLOCKS (YTONG) TH.150mm

Notes:

Note 1: wooden floor-lining plank (100x40) along the border of the room

- 1 All work to be done according to current regulations and technology rules, including health and safety.
2. In case of any doubt, uncertainty or unforeseen circumstances consultation with the architect is needed to clarify progress of work.
3. Drawings of individual professions and other documentation on the list are part of the main drawing. It is necessary to coordinate building structure drawings and adjustments made by other professions.

DETAIL:
C_CARPENTRY ELEMENTS SCHEDULE
WOODEN STAIRCASE - PLAN (FIRST FLOOR)

State of the project:	EXECUTIVE PROJECT	Drawing number:
Scale:	1 : 20	Detail 02
Date:	05 / 2011	

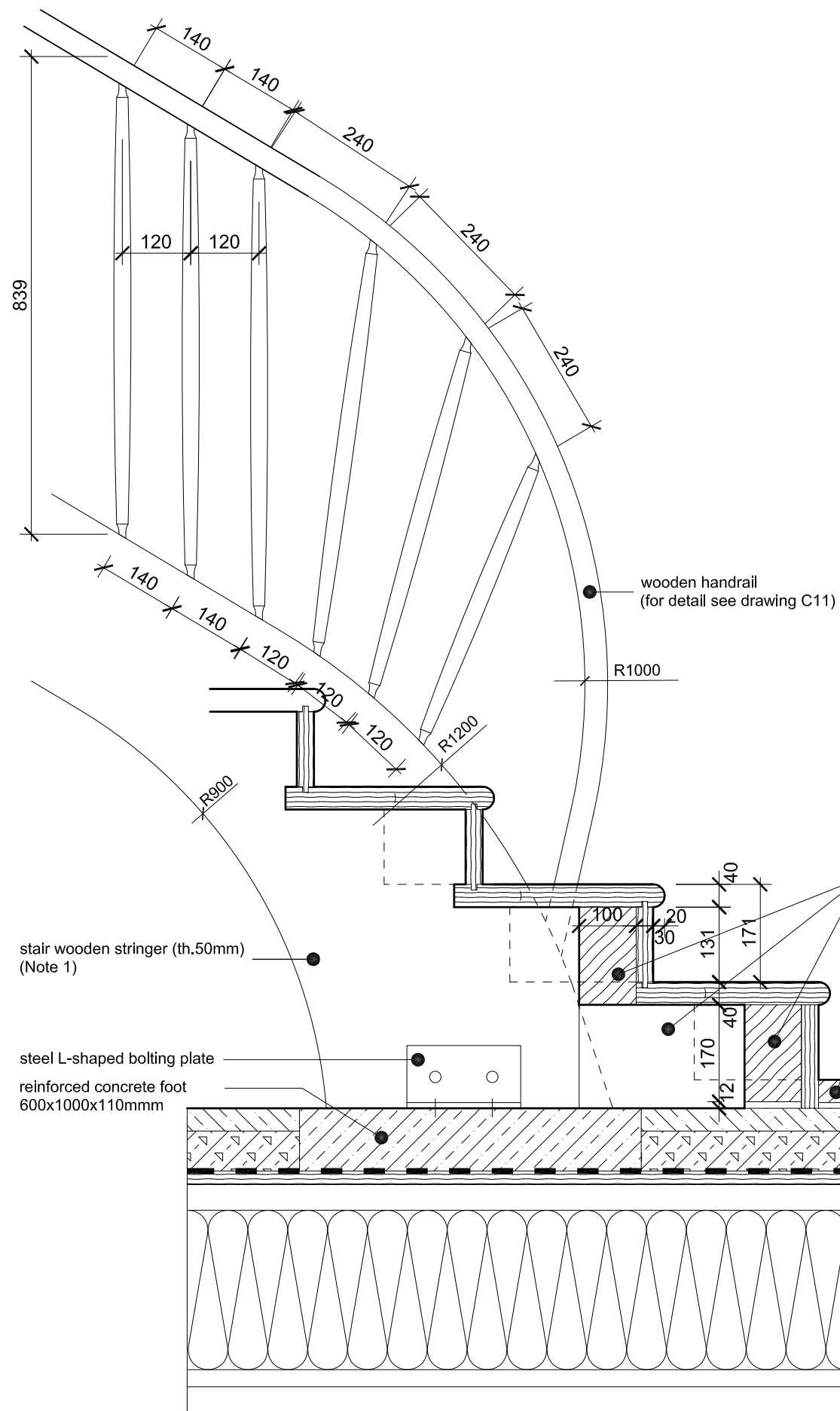

SECTION 1

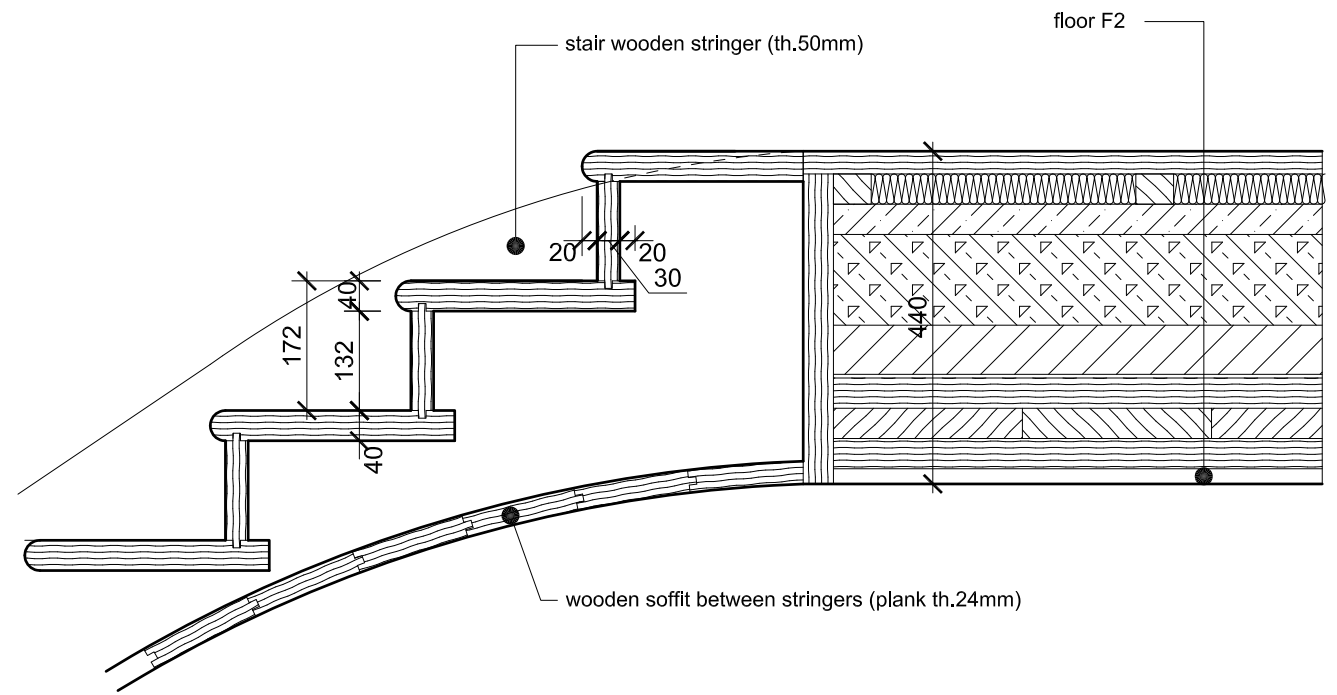

SECTION 2

Notes:

Note 1: right stair string to be fixed to the reinforced concrete foot that is concealed within floor layers (see C01 for the position)

- 1 All work to be done according to current regulations and technology rules, including health and safety.
2. In case of any doubt, uncertainty or unforeseen circumstances consultation with the architect is needed to clarify progress of work.
3. Drawings of individual professions and other documentation on the list are part of the main drawing. It is necessary to coordinate building structure drawings and adjustments made by other professions.

DETAIL: C_CARPENTRY ELEMENTS SCHEDULE WOODEN STAIRCASE - SECTION 1,2	State of the project: EXECUTIVE PROJECT	Drawing number:
	Scale: 1 : 10	Detail 03
	Date: 05 / 2011	

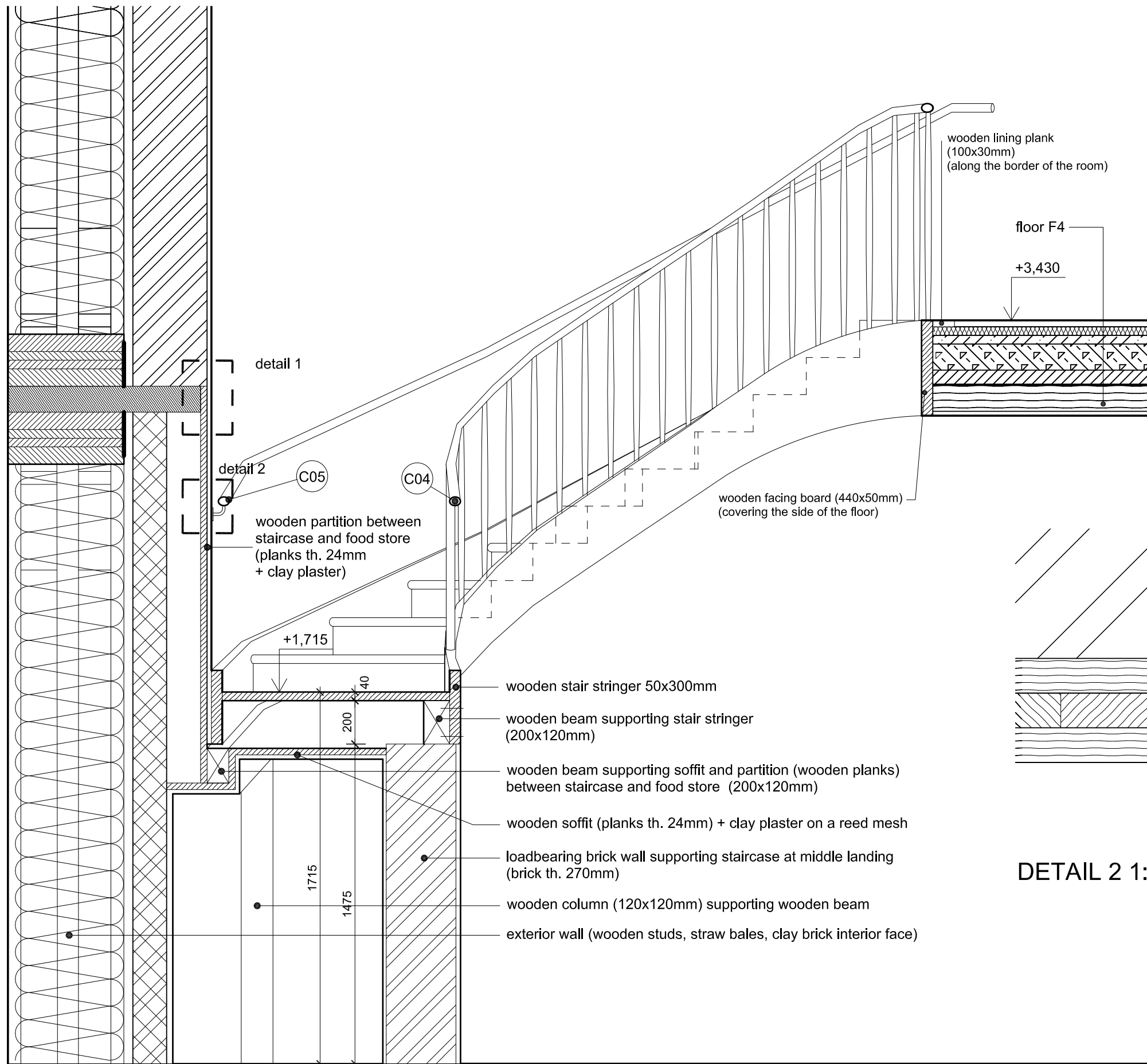

Notes:

Note 1:

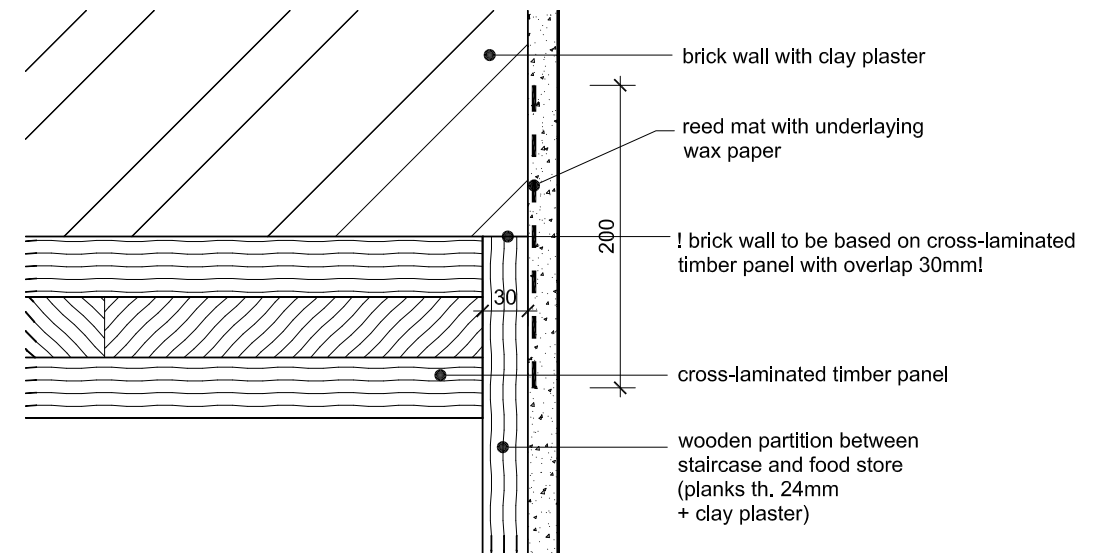
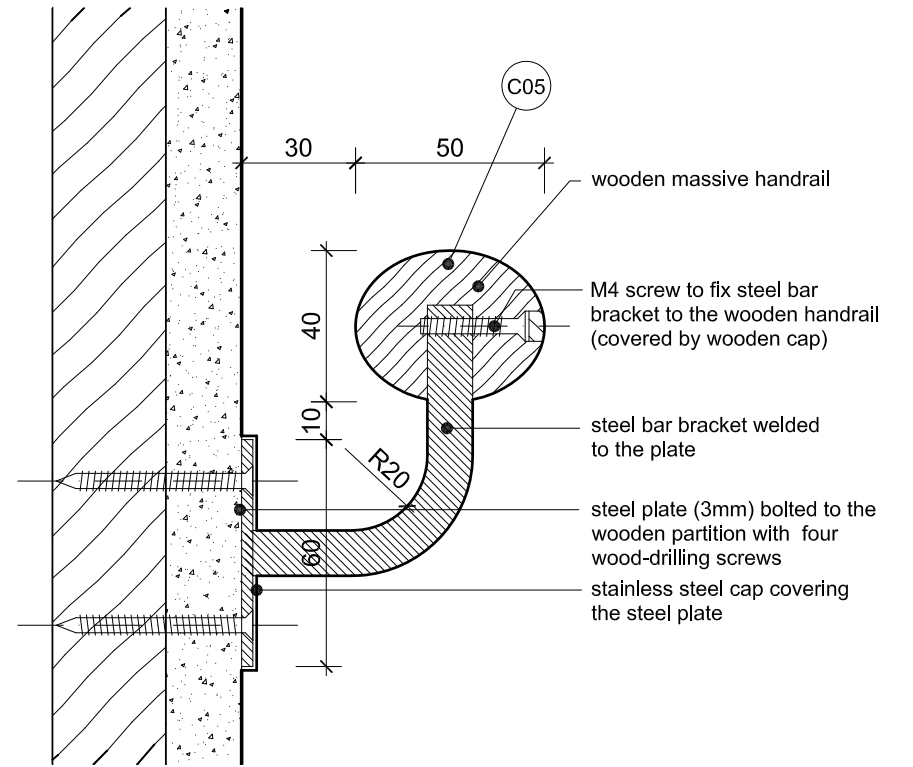

DETAIL 2 1:5

- 1 All work to be done according to current regulations and technology rules, including health and safety.
2. In case of any doubt, uncertainty or unforeseen circumstances consultation with the architect is needed to clarify progress of work.
3. Drawings of individual professions and other documentation on the list are part of the main drawing. It is necessary to coordinate building structure drawings and adjustments made by other professions.

DETAIL: C_CARPENTERY ELEMENTS SCHEDULE WOODEN STAIRCASE - SECTION 3	State of the project: EXECUTIVE PROJECT	Drawing number: <h1 style="margin: 0;">Detail 04</h1>
	Scale: 1 : 20	
	Date: 05 / 2011	

Notes:
Note 1:

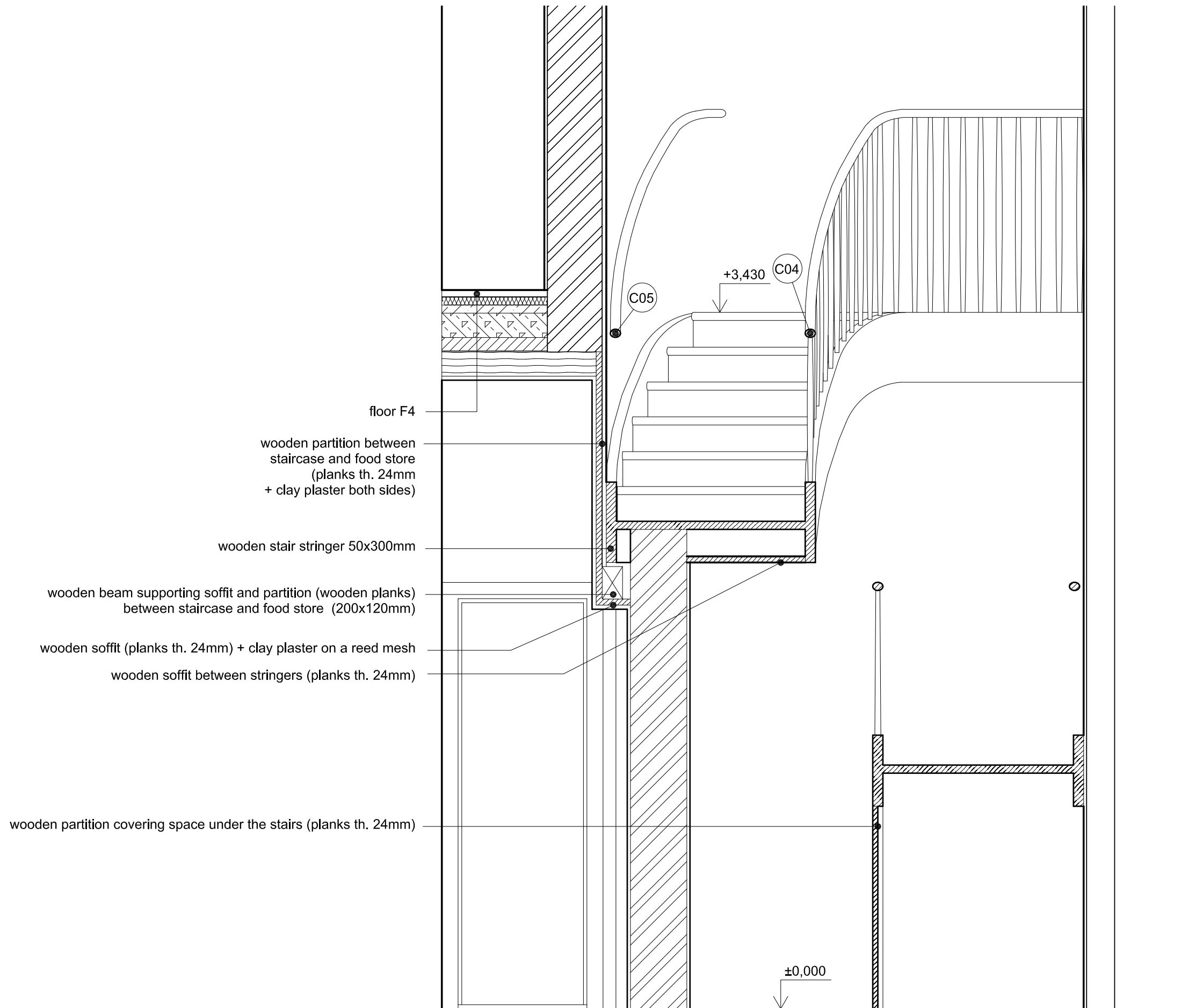

- 1 All work to be done according to current regulations and technology rules, including health and safety.
2. In case of any doubt, uncertainty or unforeseen circumstances consultation with the architect is needed to clarify progress of work.
3. Drawings of individual professions and other documentation on the list are part of the main drawing. It is necessary to coordinate building structure drawings and adjustments made by other professions.

DETAIL: CARPENTRY_ELEMENTS SCHEDULE WOODEN STAIRCASE - SECTION 4	State of the project: EXECUTIVE PROJECT	Drawing number: Detail 05
	Scale: 1 : 20	
	Date: 05 / 2011	

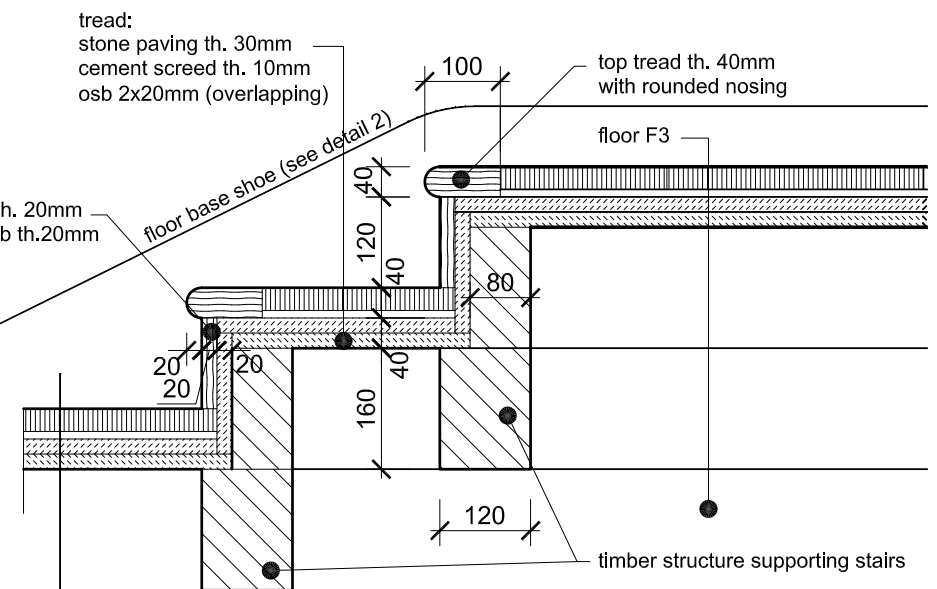
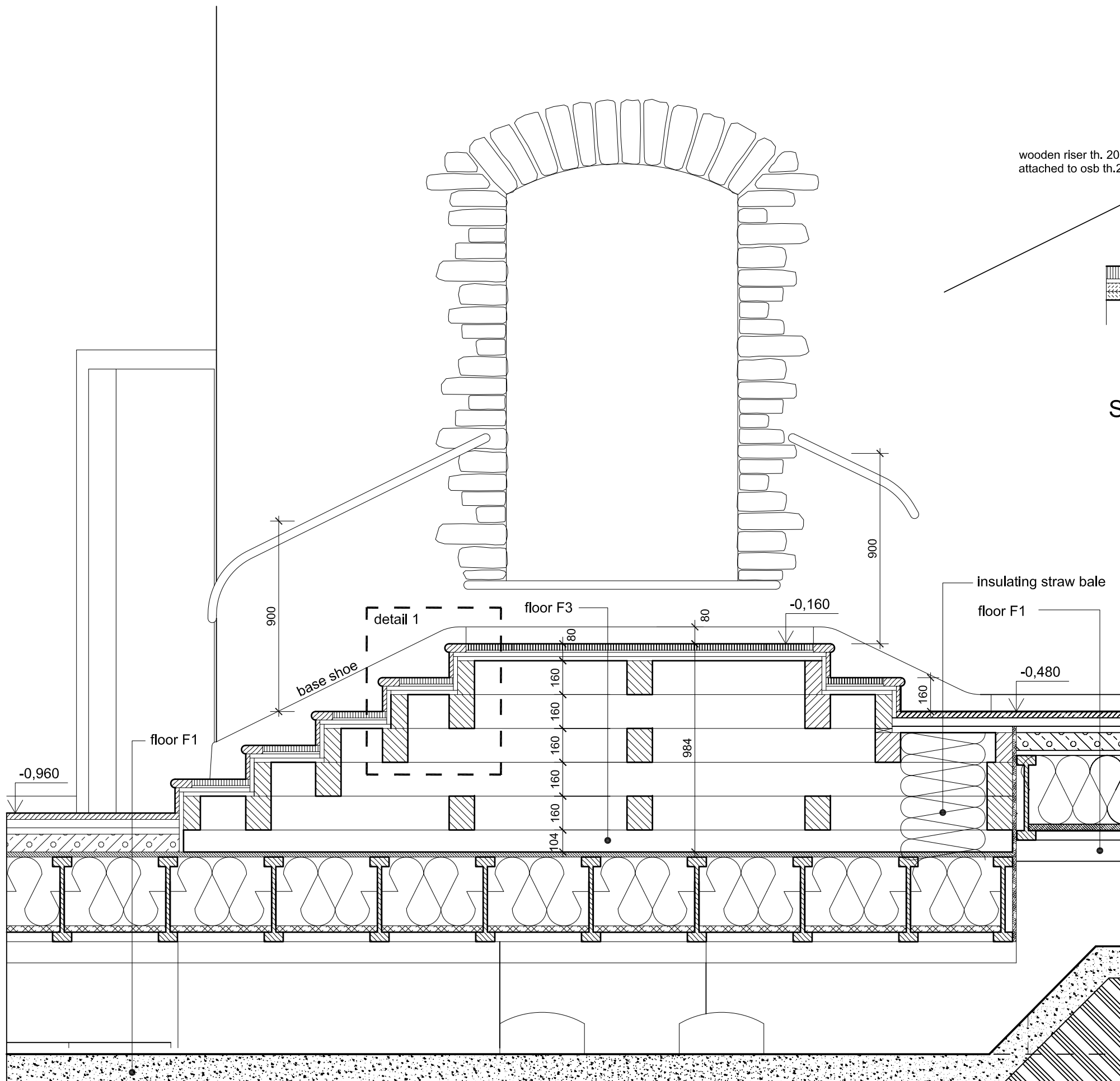

SECTION 1 1:10

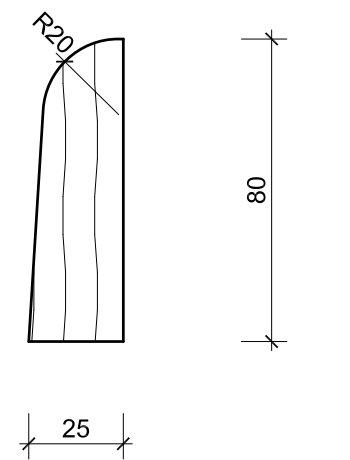

wooden massive floor base shoe

SECTION 2 1:2

- 1 All work to be done according to current regulations and technology rules, including health and safety.
2. In case of any doubt, uncertainty or unforeseen circumstances consultation with the architect is needed to clarify progress of work.
3. Drawings of individual professions and other documentation on the list are part of the main drawing. It is necessary to coordinate building structure drawings and adjustments made by other professions.

DETAIL:
C_CARPENTRY ELEMENTS SCHEDULE
WOODEN STAIRCASE - SECTION 5

State of the project:	EXECUTIVE PROJECT	Drawing number: Detail 06
Scale:	1 : 20	
Date:	05 / 2011	

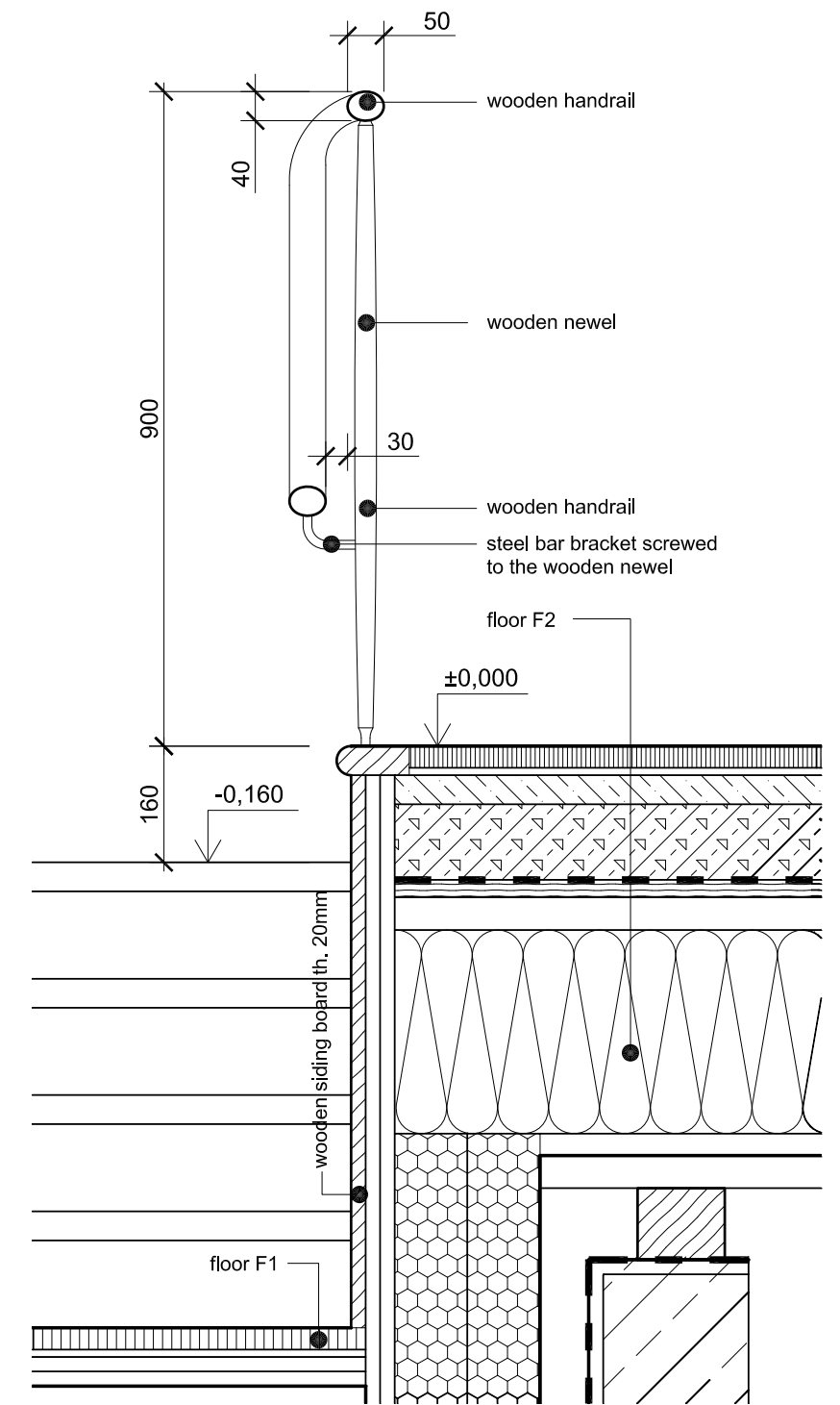
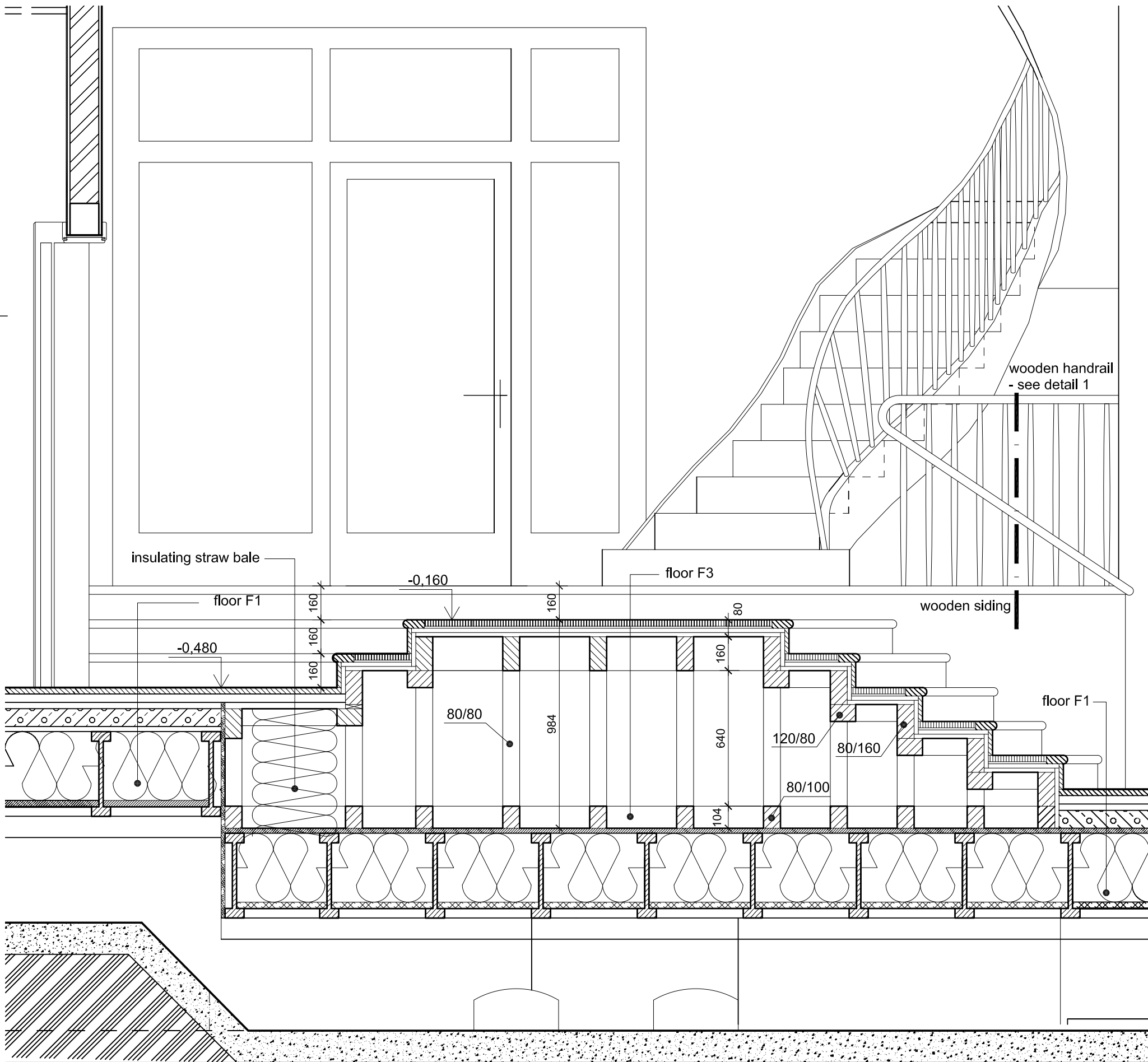

DETAIL 1 1:10

- 1 All work to be done according to current regulations and technology rules, including health and safety.
2. In case of any doubt, uncertainty or unforeseen circumstances consultation with the architect is needed to clarify progress of work.
3. Drawings of individual professions and other documentation on the list are part of the main drawing. It is necessary to coordinate building structure drawings and adjustments made by other professions.

DETAIL: C_CARPENTERY ELEMENTS SCHEDULE WOODEN STAIRCASE - SECTION 6	State of the project:	EXECUTIVE PROJECT	Drawing number: <h1>Detail 07</h1>
	Scale:	1 : 20	
	Date:	05 / 2011	

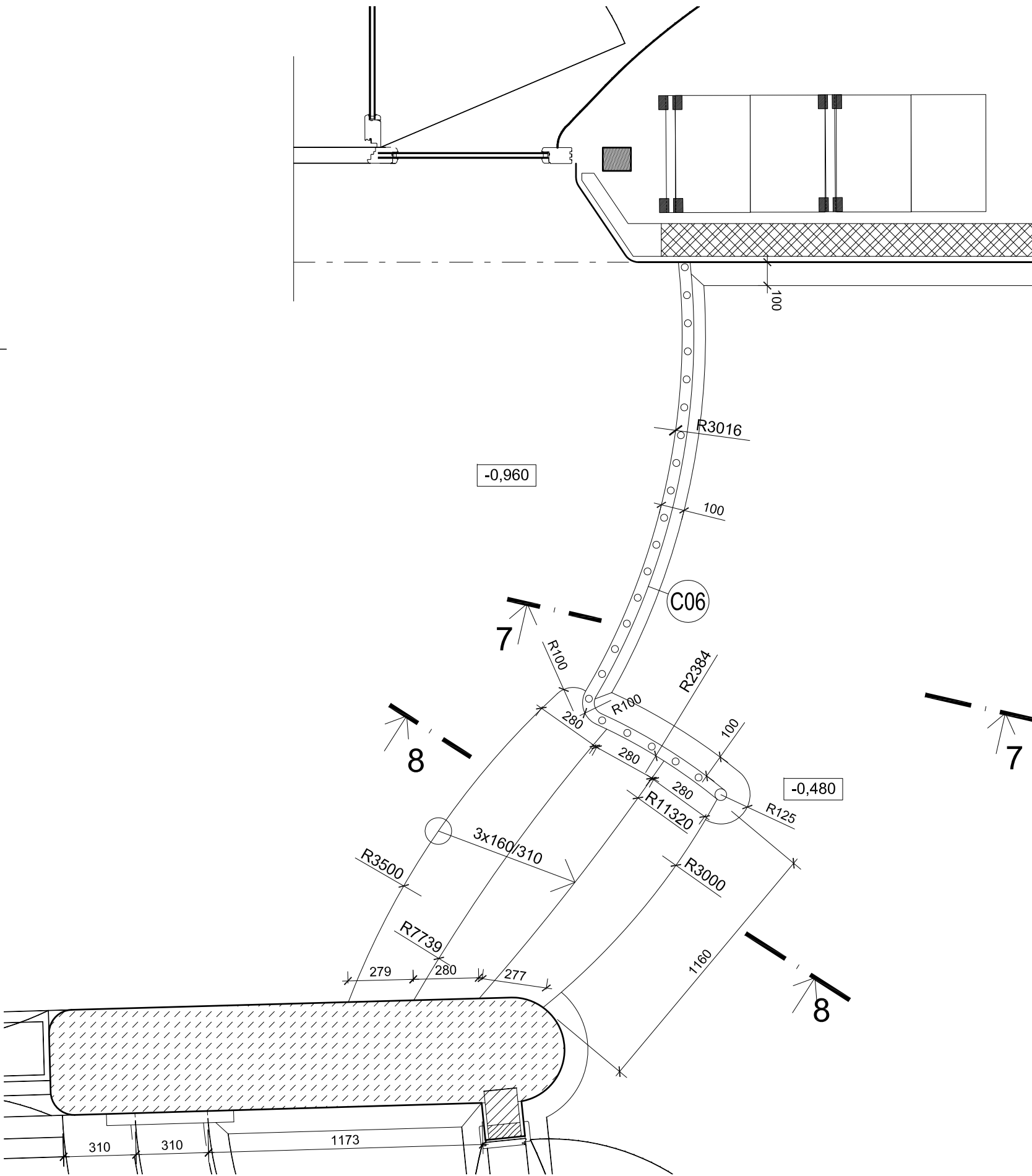

- 1 All work to be done according to current regulations and technology rules, including health and safety.
2. In case of any doubt, uncertainty or unforeseen circumstances consultation with the architect is needed to clarify progress of work.
3. Drawings of individual professions and other documentation on the list are part of the main drawing. It is necessary to coordinate building structure drawings and adjustments made by other professions.

DETAIL: CARPENTRY LIVING-ROOM STAIRCASE - PLAN	State of the project: EXECUTIVE PROJECT	Drawing number:
	Scale: 1 : 20	Detail 08
	Date: 05 / 2011	

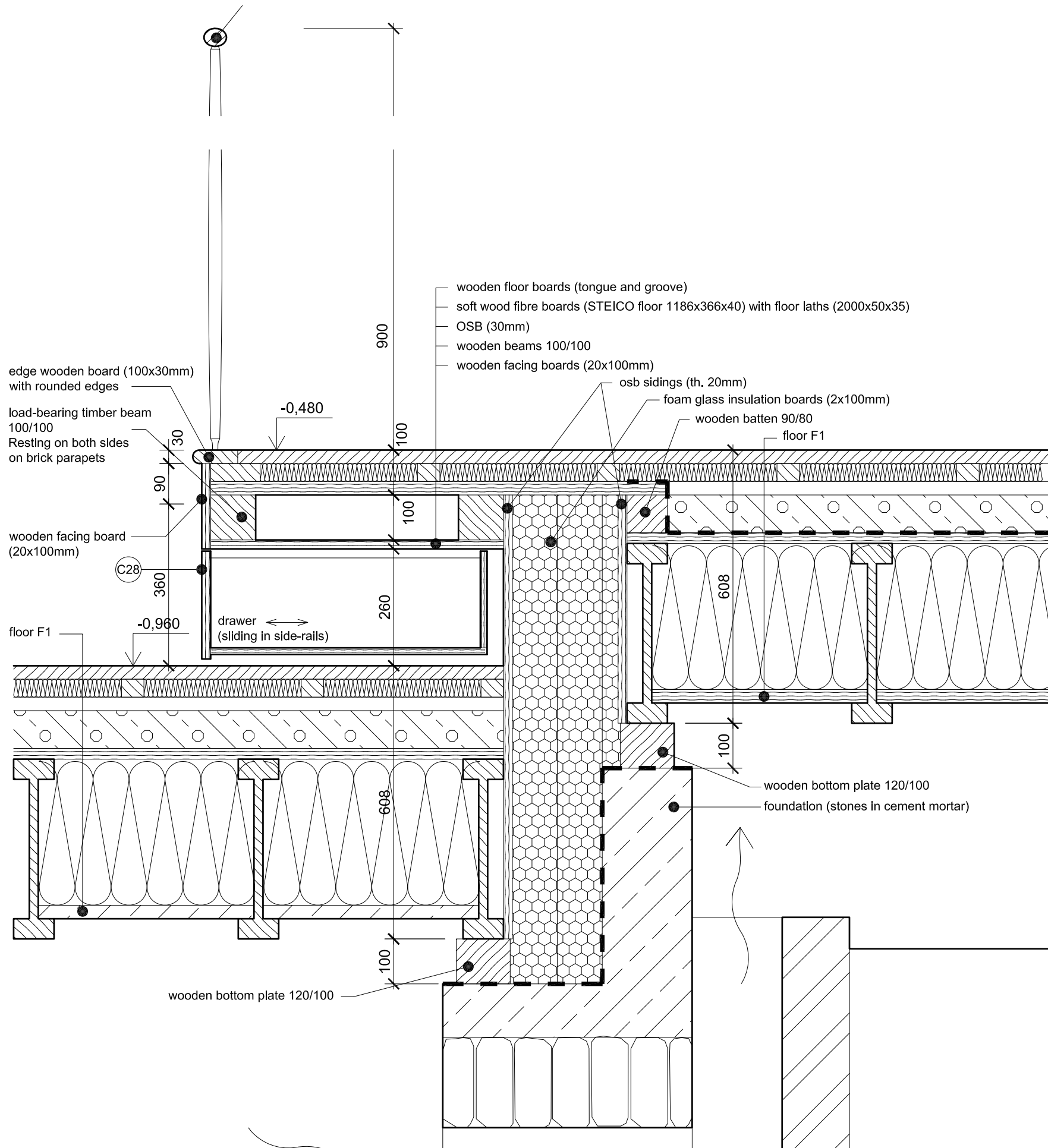

- 1 All work to be done according to current regulations and technology rules, including health and safety.
2. In case of any doubt, uncertainty or unforeseen circumstances consultation with the architect is needed to clarify progress of work.
3. Drawings of individual professions and other documentation on the list are part of the main drawing. It is necessary to coordinate building structure drawings and adjustments made by other professions.

DETAIL: CARPENTRY WOODEN STAIRCASE - SECTION 7	State of the project: EXECUTIVE PROJECT	Drawing number:
	Scale: 1 : 10	Detail 09
	Date: 05 / 2011	

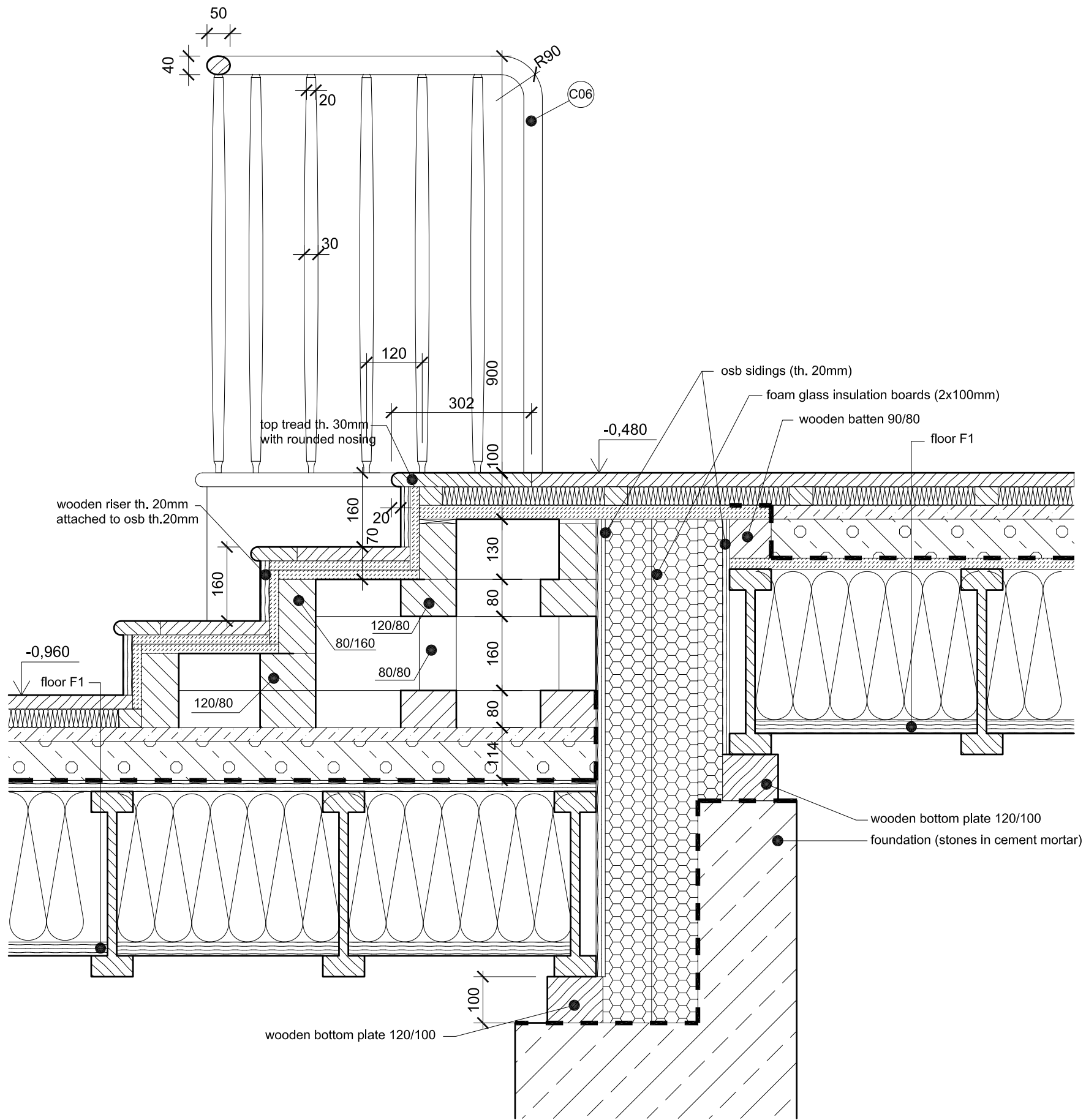

- 1 All work to be done according to current regulations and technology rules, including health and safety.
2. In case of any doubt, uncertainty or unforeseen circumstances consultation with the architect is needed to clarify progress of work.
3. Drawings of individual professions and other documentation on the list are part of the main drawing. It is necessary to coordinate building structure drawings and adjustments made by other professions.

DETAIL: CARPENTRY WOODEN STAIRCASE - SECTION 8	State of the project: EXECUTIVE PROJECT	Drawing number: Detail 10
	Scale: 1 : 20	
	Date: 05 / 2011	

Notes:

Note 1:

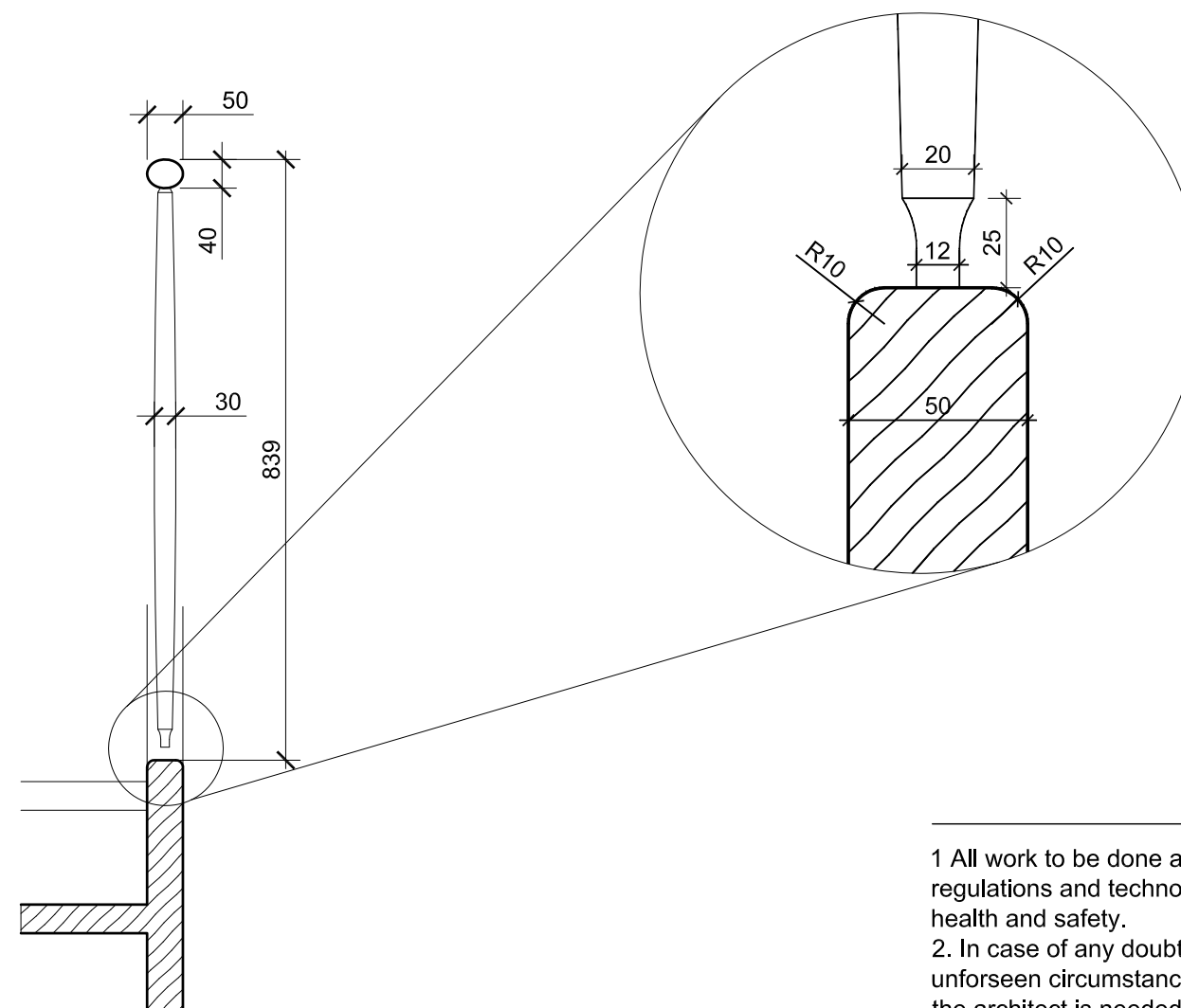
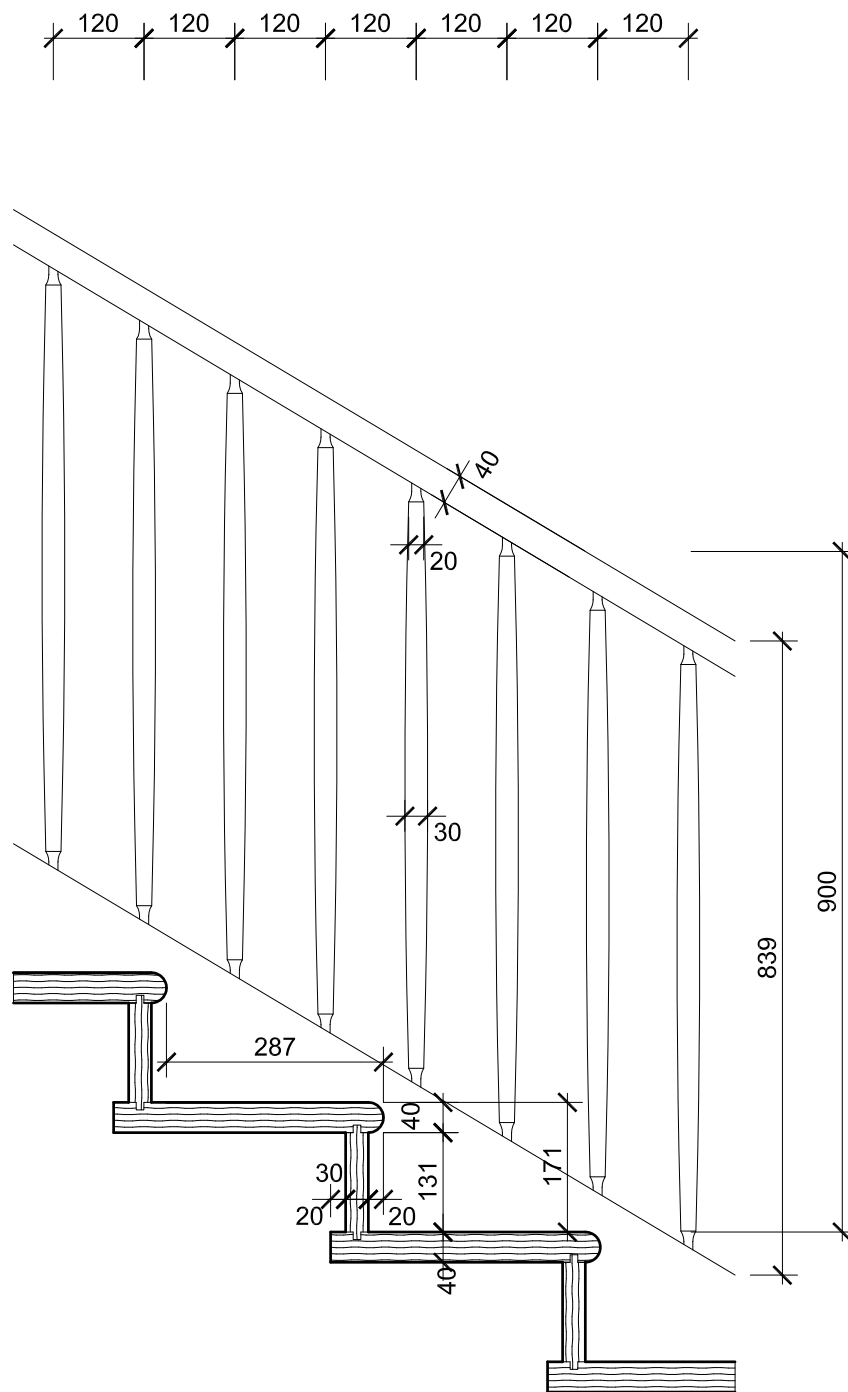

- 1 All work to be done according to current regulations and technology rules, including health and safety.
2. In case of any doubt, uncertainty or unforeseen circumstances consultation with the architect is needed to clarify progress of work.
3. Drawings of individual professions and other documentation on the list are part of the main drawing. It is necessary to coordinate building structure drawings and adjustments made by other professions.

DETAIL: CARPENTRY WOODEN STAIRCASE - HANDRAIL DETAIL	State of the project:	EXECUTIVE PROJECT	Drawing number: Detail 11
	Scale:	1 : 10	
	Date:	05 / 2011	

BALCONY RAILING - SMALL PART IN LOWERED ARE OF BALCONY

m 1:10

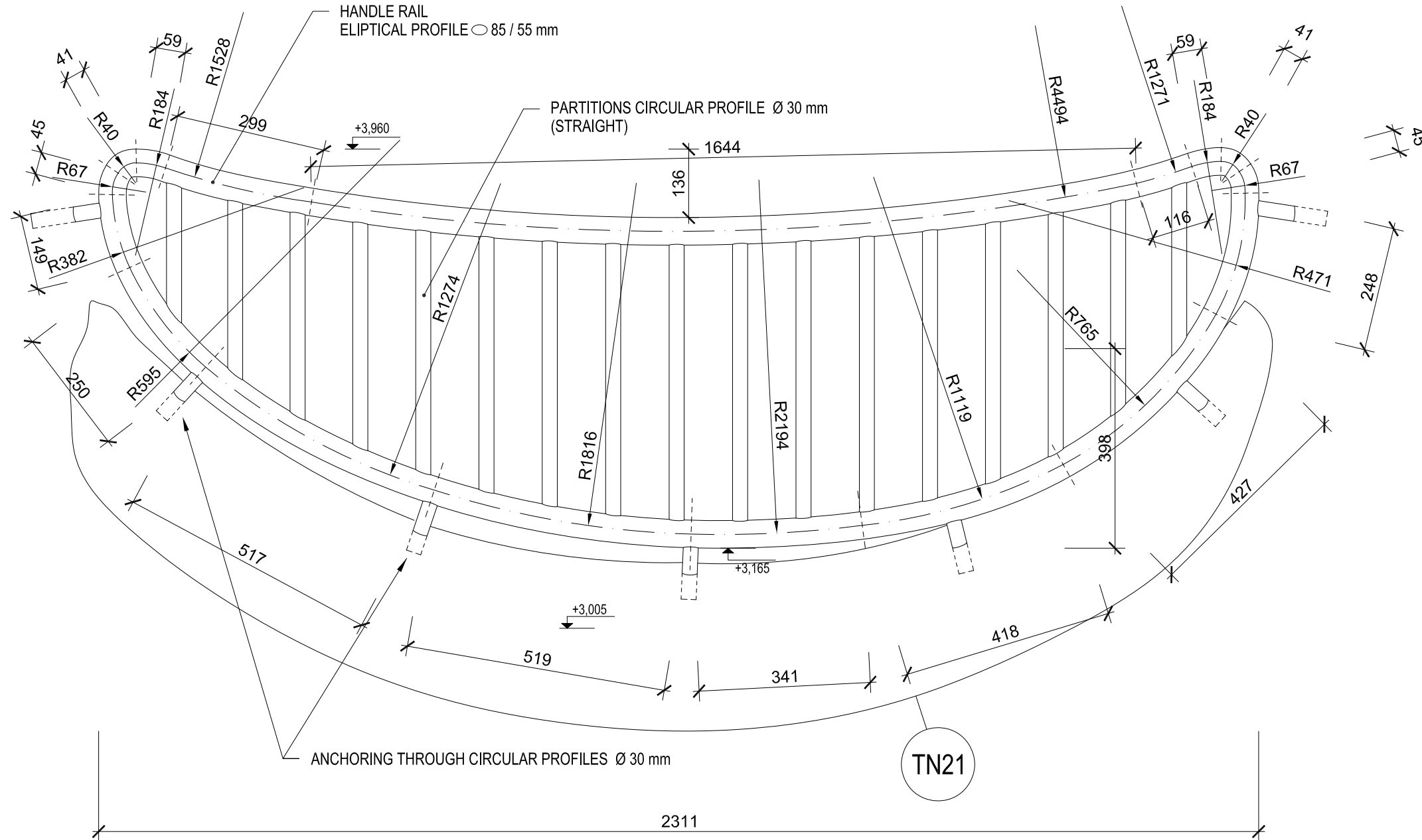

Notes:

Note 1: Exact measurements to be taken on site prior to construction.

Note 2: Bottom rail copying loosely shape of attic. Space between the rail and attic at about 100 mm.

- 1 All work to be done according to current regulations and technology rules, including health and safety.
2. In case of any doubt, uncertainty or unforeseen circumstances consultation with the architect is needed to clarify progress of work.
3. Drawings of individual professions and other documentation on the list are part of the main drawing. It is necessary to coordinate building structure drawings and adjustments made by other professions.

DETAIL: CARPENTRY WOODEN STAIRCASE - HANDRAIL DETAIL	State of the project: EXECUTIVE PROJECT	Drawing number: Detail 15
	Scale: 1 : 10	
	Date: 05 / 2011	

SPIRAL ENDING ELEMENT - TERRACE'S RAILING m 1:20

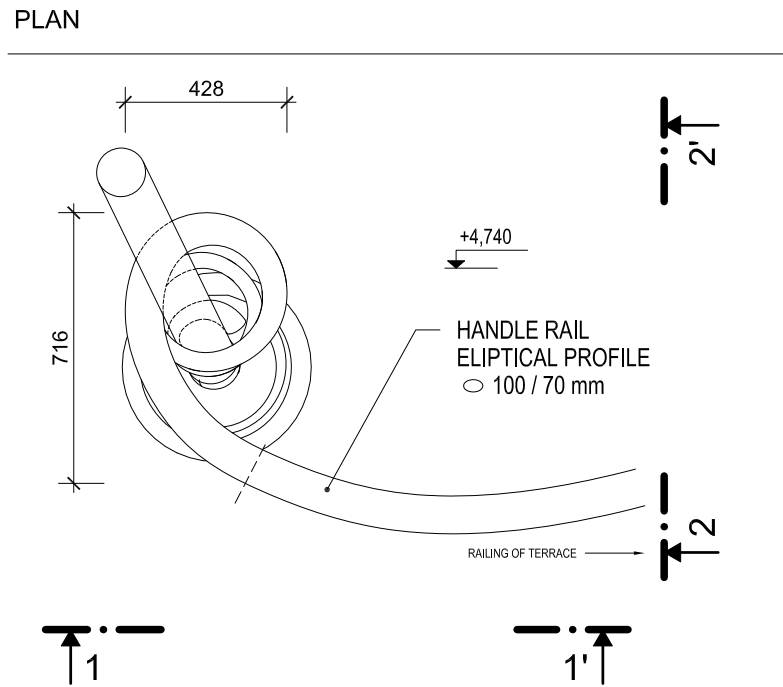
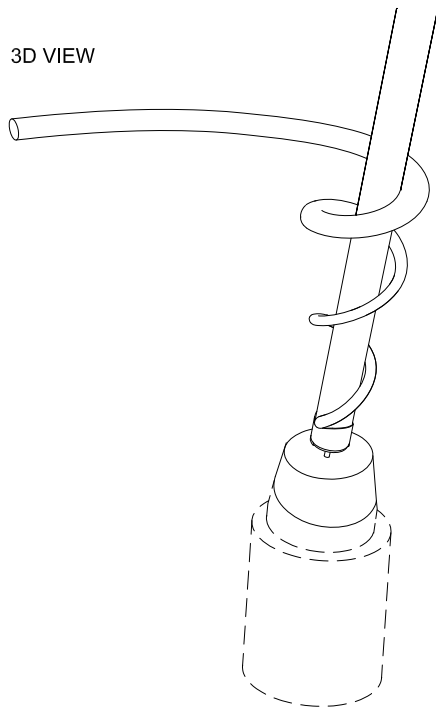

ELEVATION 1-1'

ELEVATION 2-2'

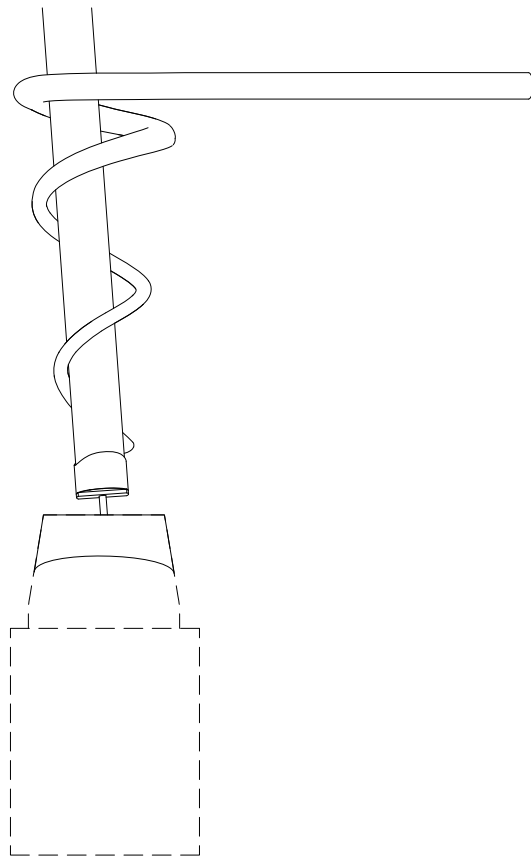

1008

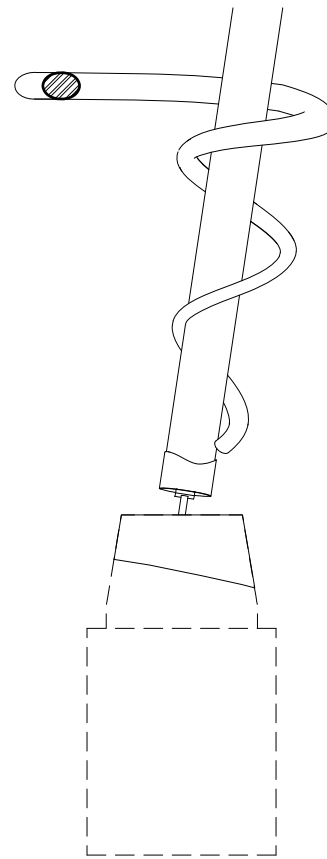

Notes:

Note 1: Exact measurements to be taken on site prior to construction.

- 1 All work to be done according to current regulations and technology rules, including health and safety.
2. In case of any doubt, uncertainty or unforeseen circumstances consultation with the architect is needed to clarify progress of work.
3. Drawings of individual professions and other documentation on the list are part of the main drawing. It is necessary to coordinate building structure drawings and adjustments made by other professions.

DETAIL: CARPENTRY TERRACE RAILING - SPIRAL ENDING OF HANDRAIL	State of the project: EXECUTIVE PROJECT	Drawing number: Detail 16
	Scale: 1 : 20	
	Date: 05 / 2011	